

**OUR
CHILDREN,
OUR
COMMUNITY,
OUR
FUTURE.**

**Stakeholder Update
February 2011**

Parishes of Saint Vincent de Paul,
Holy Cross and Sacred Heart.



Contents

- **Background**
- **Vision**
- **Early Work**
- **Review of 2010**
 - **Submission to PPRCE**
 - **Potential Post Primary School Design**
 - **Primary and Nursery School Feasibility**
- **Next Steps**



Parish Boundaries



Strategic Background

- **Closure of St. Gabriel's – leaving no post-primary provision for boys within the 3 parish boundary**
- **Falling enrolments at Our Lady of Mercy and St. Gemma's – as well as other schools across North Belfast**
- **Falling enrolments in primary schools and general poor condition of current primary school buildings**
- **Entitlement Framework**
 - **Minimum of 24 courses at Key Stage 4 and 27 courses at post-16**
- **The Report of the Independent Strategic Review of Education, chaired by Professor Sir George Bain, (known as the “Bain Report”)**
- **Area Based Planning**
- **Post Primary Review of Catholic Education**



ETG Background

- Educational Task Group was developed out of an Educational Conference hosted by the Ardoyne Association at Lansdowne Hotel in April 2008
- Conference invited by Bishop McKeown to work in partnership with our local educators, clergy and community to create an Educational Vision of the Future in the parishes of Saint Vincent de Paul, Holy Cross and Sacred Heart
- Education Task Group stakeholder representatives agreed at conference



ETG Vision

- **The Education Task Group's vision for Catholic education in the parishes of Saint Vincent de Paul, Holy Cross and Sacred Heart is for a new co-educational primary and nursery school in each of our three local parishes working in close partnership with a new co-educational all-ability post-primary school at the heart of our community.**
- **These schools will deliver the best quality education for our children, as well as creating adult education opportunities for those who want to improve their education and go on to college or university; importantly the schools' facilities would also be extended for wider community use.**



Early ETG Work

- Initial focus on Post Primary School vision
- Full assessment of options
- Pupil number forecasts developed
 - Macro models developed by Oxford Economics
 - Assessment of baptism statistics and nursery/primary enrolment figures
- Forecasts showed a levelling out of pupil numbers with slight upturn, with forecasts of approximately 1,400 11-19 aged school children from within the three parishes
- Agreed vision for a new **co-educational all ability 11-19** school on a suitable site in the area
- Assessment of site options recommended the old St Gabriel's site and Holy Cross Girls Primary School site



Area Based Planning

Educational Task Group Submission to the Post-Primary Area Based Planning Exercise (Belfast Local Area Group)

Post-primary Area Based Planning Exercise
Submission Pro-forma

Section1: Vision

Key question: What principles underpin and inform your submission?

As background, our Group, the Education Task Group based in North Belfast, was set up following a community education conference at the Lansdowne Hotel on the 12th April 2008, at which Bishop McKeown invited the communities of the Sacred Heart, Holy Cross and St. Vincent de Paul parishes in North Belfast to formulate a proposal for submission to the Northern Ireland Commission for Catholic Education Post Primary Review, with the related objective of also working with the Area Based Planning Exercise as appropriate. The Group is community led and made up of representatives from the nursery, primary and post-primary school principals and boards of governors in the Catholic Maintained Sector, as well as representatives from the community.

The Group is strongly of the view that post-primary provision should not be considered in isolation and that a lifelong education solution must be developed for the area from nursery through to adult education. The Group considers that education is at the heart of the rebuilding and regenerating of this area of North Belfast and its community; a community that has suffered a great deal during the troubles and with subsequent sectarian disputes. We are therefore working on a wider vision than that set out in this submission, which only sets out that part of our vision relating to post-primary provision in line with the requirements of the current Area Based Planning Exercise for Post-Primary Education. We would welcome the opportunity to share this wider vision with you at an appropriate time in the future.

Fundamental to our vision at all levels is the creation of stronger links between all the schools in the North Belfast Area Learning Community (and beyond where appropriate) that will provide community based and inter-community educational opportunities for all, including collaboration opportunities with local colleges and universities.

Following consideration of a long-list of potential options for the provision of post-primary education in the area, the Group has set out its vision for:

A new co-educational all ability 11-19 school on a suitable site in the area, formed initially from the pupils of Our Lady of Mercy and St. Gemma's.

The new school will be a place of excellent high quality education for all abilities, building on the academic, vocational and pastoral care strengths of both Our Lady of Mercy and St. Gemma's; whilst offering a new start for boys' post-primary education in this area of North Belfast. It will be founded on a strong

30th January 2009 Page 1

- Detailed submission (102 pages) made to Post Primary Area Based Planning Exercise in January 2009
- Informal feedback received was very positive both in terms of quality of submission and the merit of the proposal



PPRCE Consultation

4 SCHOOL MODEL:

11-19 Co-Educational School at Little Flower/ St Patrick College Site(s)

11-19 Boys' School at St Malachy's College

Co-Educational School at Edmund Rice College Site

11-19 Girls' School at Dominican College

ALL North Belfast schools located along Antrim Road!

5 SCHOOL MODEL:

11-19 Co-Educational School at Little Flower/ St Patrick College Site(s)

11-19 Boys' School at St Malachy's College

11-19 Co-Educational School at Edmund Rice College Site

11-19 Girls' School at Dominican College

plus

11-19 Co-Educational School at a site in St Vincent de Paul, Holy Cross & Sacred Heart parishes



PPRCE Consultation

MAP:
EXISTING
NORTH
BELFAST
SCHOOL
LAYOUT

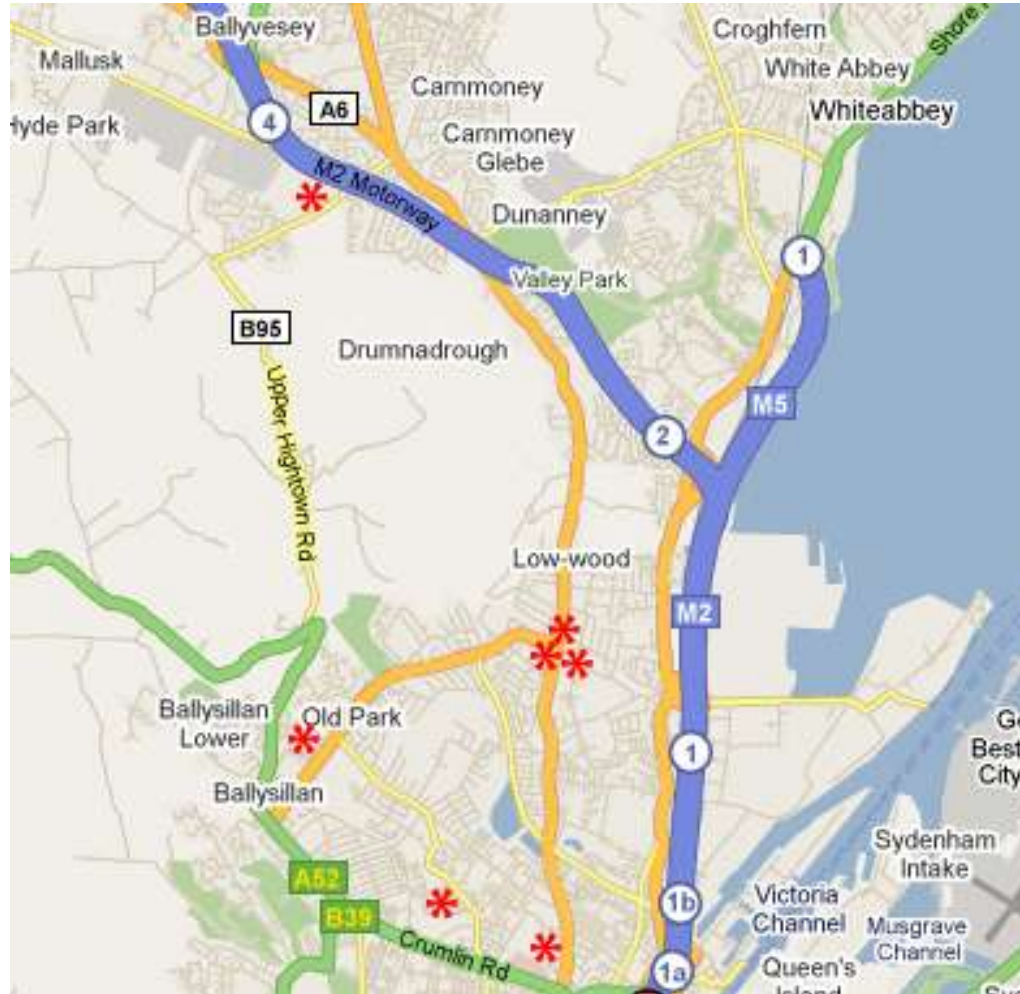

PPRCE Consultation

MAP:
4
SCHOOL
MODEL
LAYOUT



PPRCE Consultation

MAP:
5
SCHOOL
MODEL
LAYOUT

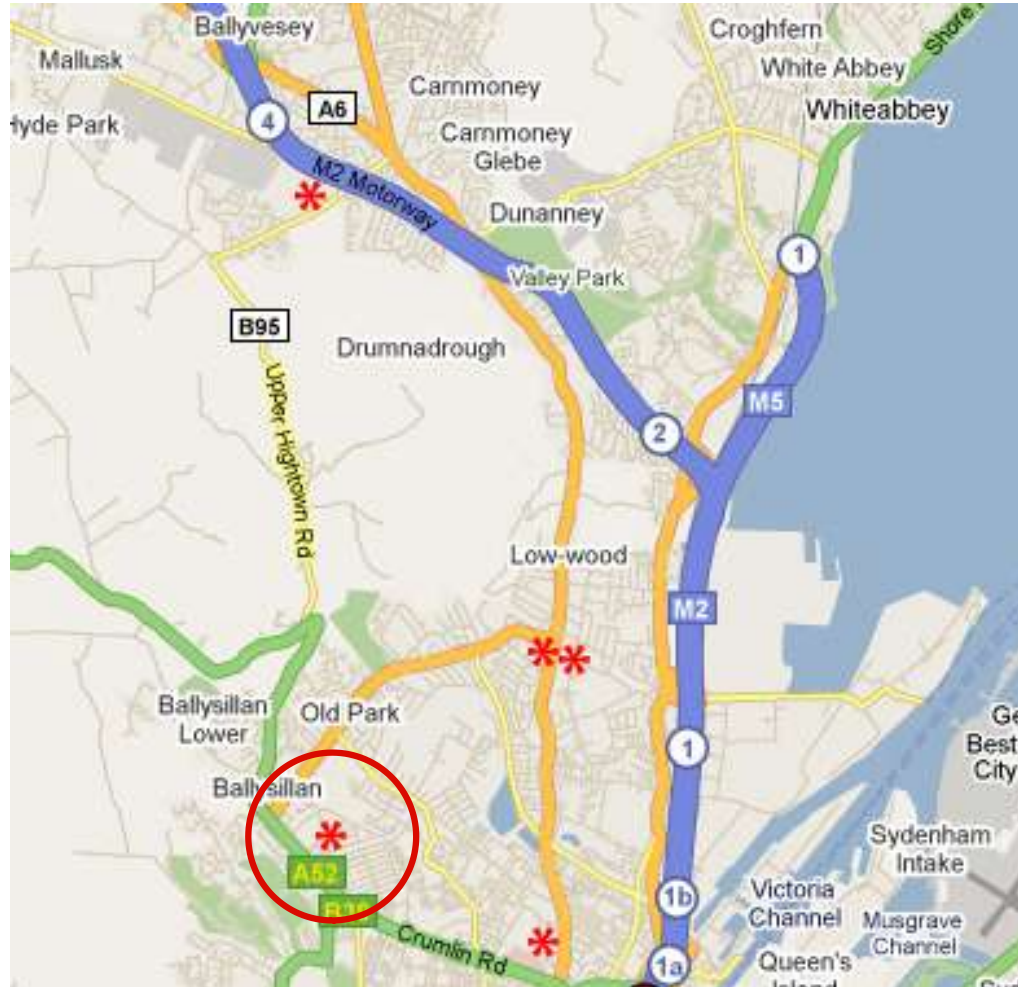

PPRCE Community Response



Over 4,000 individual responses supporting the need for a new post-primary school within the parishes of St Vincent de Paul, Holy Cross and Sacred Heart



PPRCE ETG Response

- The Education Task Group supports Option 2 in so far as it delivers a new post-primary school into our area of North Belfast
- However we believe that neither option presented delivers the best for all children across the wider North Belfast and Glengormley area
- Further options need to be considered in respect of the schools serving the communities along the Antrim Road, which in our view should be all co-educational all-ability schools



WHAT COULD A NEW POST PRIMARY SCHOOL LOOK LIKE?



WHAT COULD A **NEW POST PRIMARY SCHOOL** LOOK LIKE?



WHAT COULD A NEW POST PRIMARY SCHOOL LOOK LIKE?

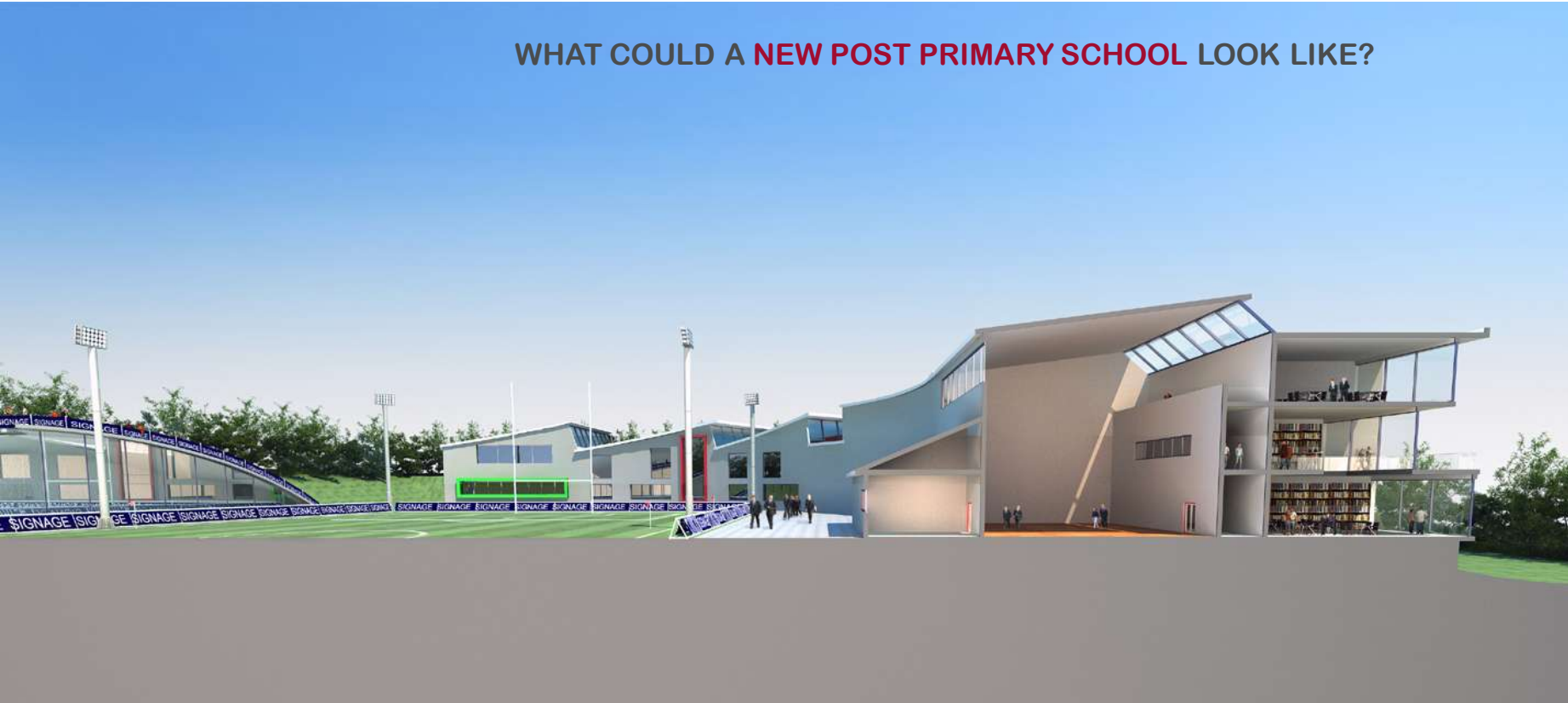

THE WIDER VISION

- A 'federation' of nursery, primary and post-primary schools across the 3 parishes working together
- Shared governance and leadership across the schools
- Primary schools working closely with the post-primary school and essentially becoming 'feeder' schools
- Primary schools utilising the wide range of facilities at the post-primary school (smoother transition)
- Primary 7 year is not lost to Academic Selection tests
- Year 8 is not lost to children trying to find their place at 'Big School'
- A natural progression from primary to post-primary to higher & further leading to a better education for more pupils



Primary and Nursery Feasibility

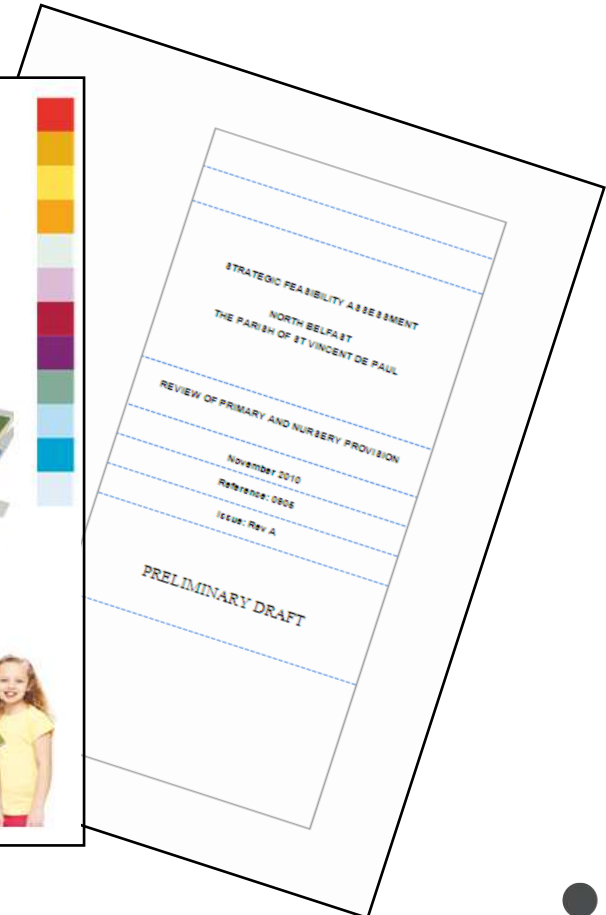
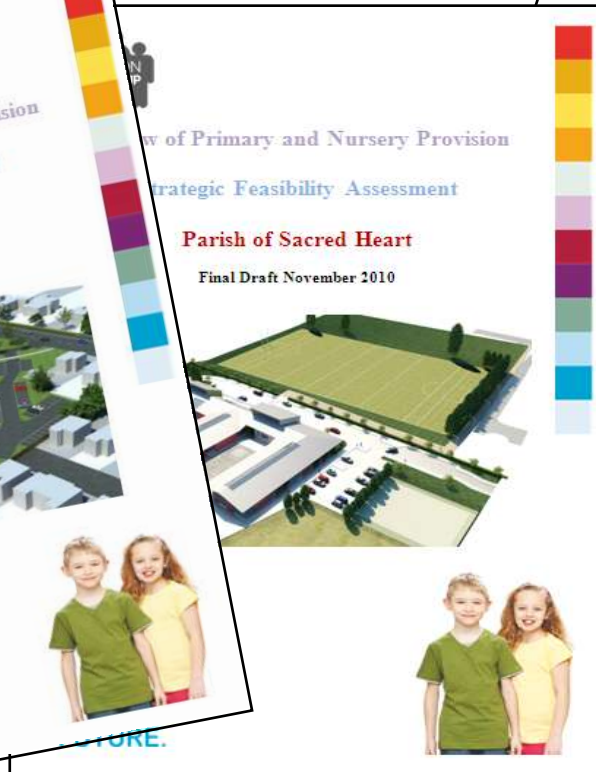



**Design Feasibility Study for new primary school on existing
Mercy Primary School Site, Crumlin Road, Belfast
AERIAL VIEW**

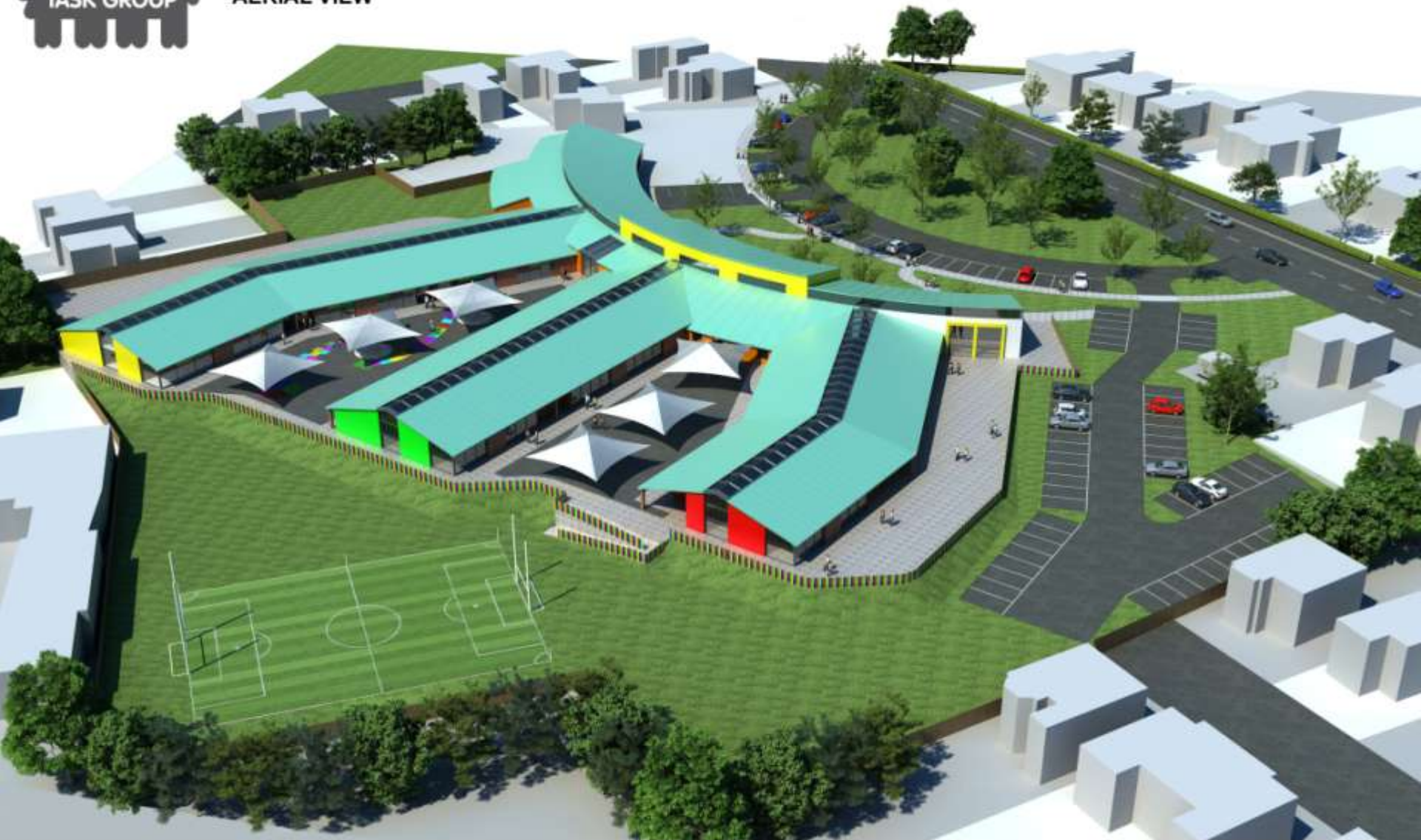



**Design Feasibility Study for
new primary school on existing Mercy Primary School Site, Crumlin Road, Belfast
PROPOSED ENTRANCE VIEW**





**Design Feasibility Study for
new primary school on existing Mercy Primary School Site, Crumlin Road, Belfast
PROPOSED CHILDREN PLAY AREA**





Design Feasibility Study for post primary school on existing St. Gabriel's School Site, Crumlin Road, Belfast

CONCEPT AERIAL VIEW IN CONTEXT - CREATION OF N.BELFAST EDUCATIONAL CAMPUS



Primary and Nursery Feasibility

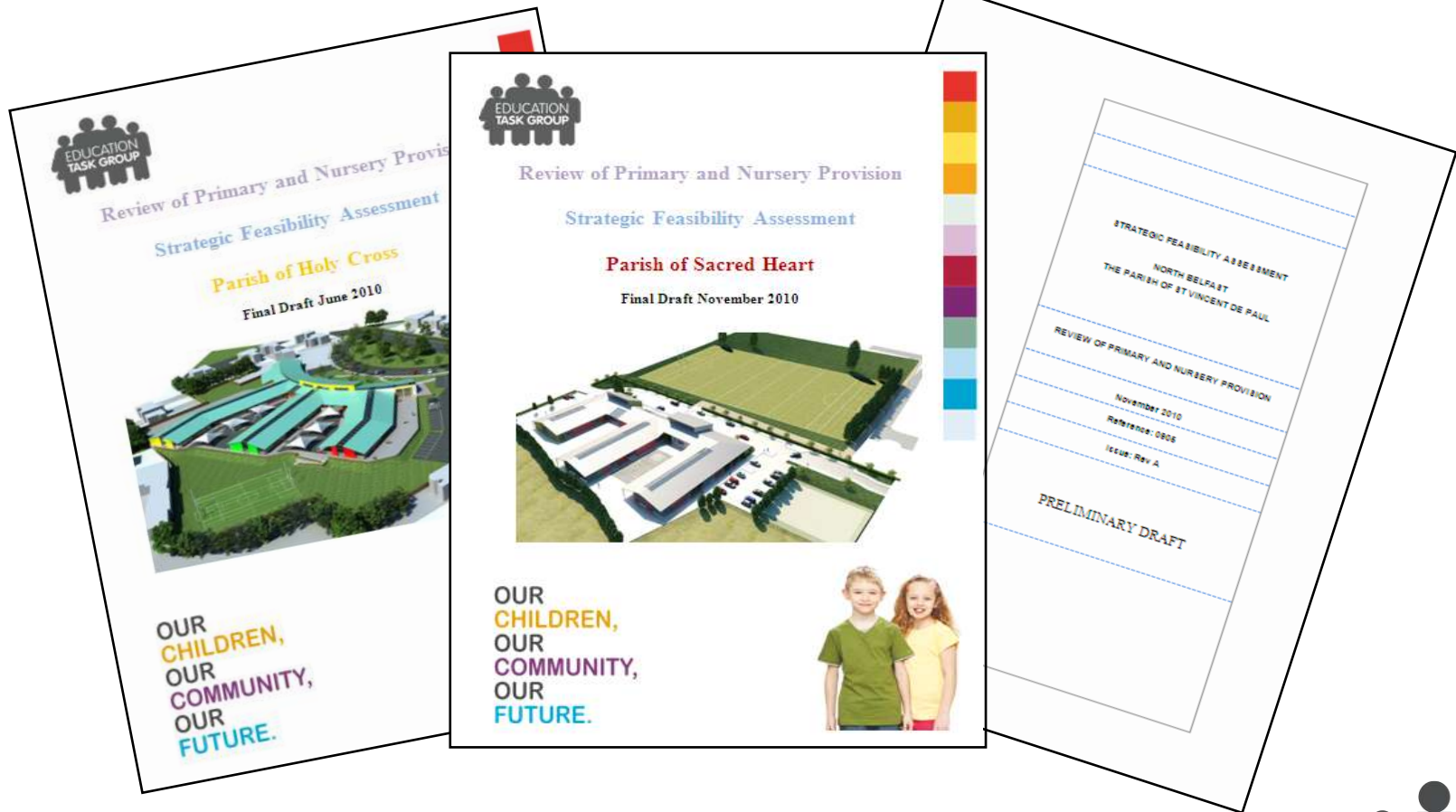



Design Feasibility Study for new primary school on existing Sacred Heart Boys Primary School Site

PROPOSED AERIAL VIEW





Design Feasibility Study Sacred Heart primary school Entrance view



BOYD
THE BOYD PARTNERSHIP
CHARTERED ARCHITECTS LLP

SHARED SURFACES - SCHOOL ZONE

Primary and Nursery Feasibility



Next Steps

- **Complete Saint Vincent de Paul Primary and Nursery School Feasibility Study**
- **Develop Economic Appraisal for Post Primary School and Holy Cross Primary and Nursery Schools**
- **Exploration of funding options and structures with key funding and asset owning stakeholders:**
 - Department of Education
 - Diocese of Down and Connor (St MacNissi's Trust)
 - Sisters of Mercy
 - Flax Trust – who have pledged an endowment of £10m to the communities of the three parishes for the development of education in the area

